

## 7. Network and Load connections

Legend:

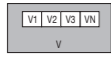

DIRIS Digiware U

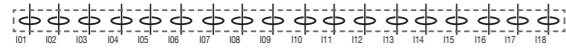

DIRIS Digiware BCM



Load

Fuse: 0.5 A gG / BS 88 2 A gG  
0.5 A class CC

For connection to IT system earthing, adapt the protection in accordance with the installation standards.

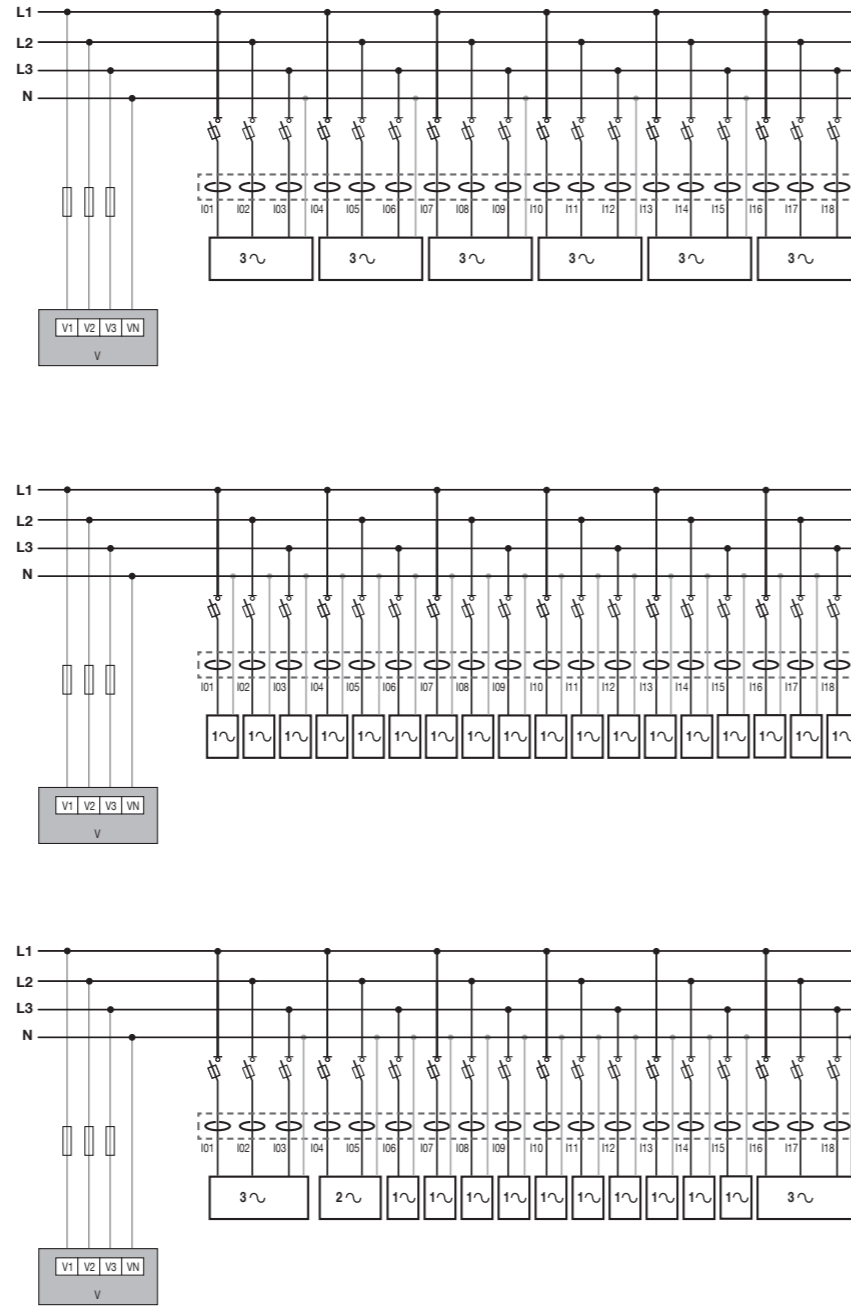

## 8. Configuration with Easy Config System

### USB through D-xx display or M-xx gateway

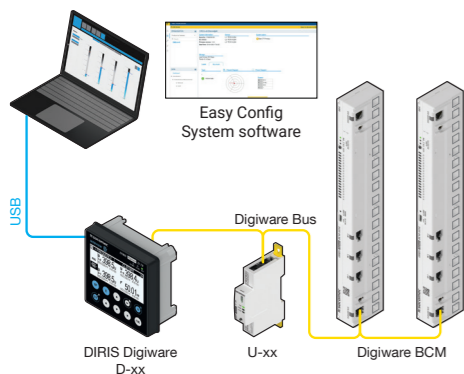

### Ethernet through D-xx display or M-xx gateway

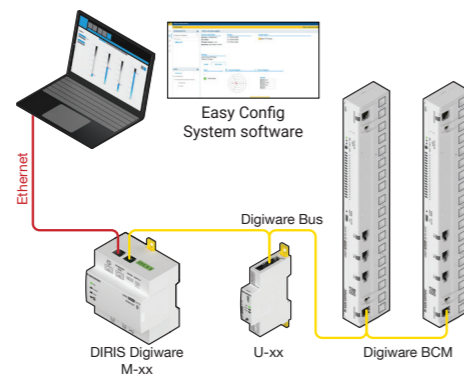

### Direct USB

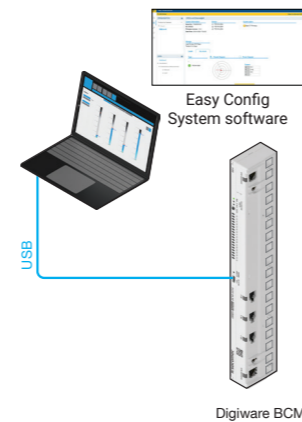

## QUICK START GUIDE

EN

**socomec**  
Innovative Power Solutions



552081B

## Branch-circuit Meter – 18 circuits DIRIS Digiware BCM-1818



Full manual #542875  
Socomec Resource Center  
To download, brochures, catalogues  
and technical manuals

DIRIS Digiware BCM model	BCM-1818	BCM-1818VM
# of circuits	18	18
Pitch	18 mm	18 mm
Imax	80 A	80 A
Breaker Status		•
Part no.	4829 0165	4829 0166

## 1. System wiring – exploded view

- Use RJ45 Digiware Bus cables (UTP RJ45 straight, twisted pairs, unshielded, AWG24, 300V, cat.III. rated, -20 / +70 °C) between all DIRIS Digiware modules.
- Use SOCOMEC RJ12 cables (UTP unshielded, twisted pair, straight, AWG24, 600V, CATV, -10 ... +70°C.
- Do not put USB or RJ45 connectors in contact with hazardous voltage.

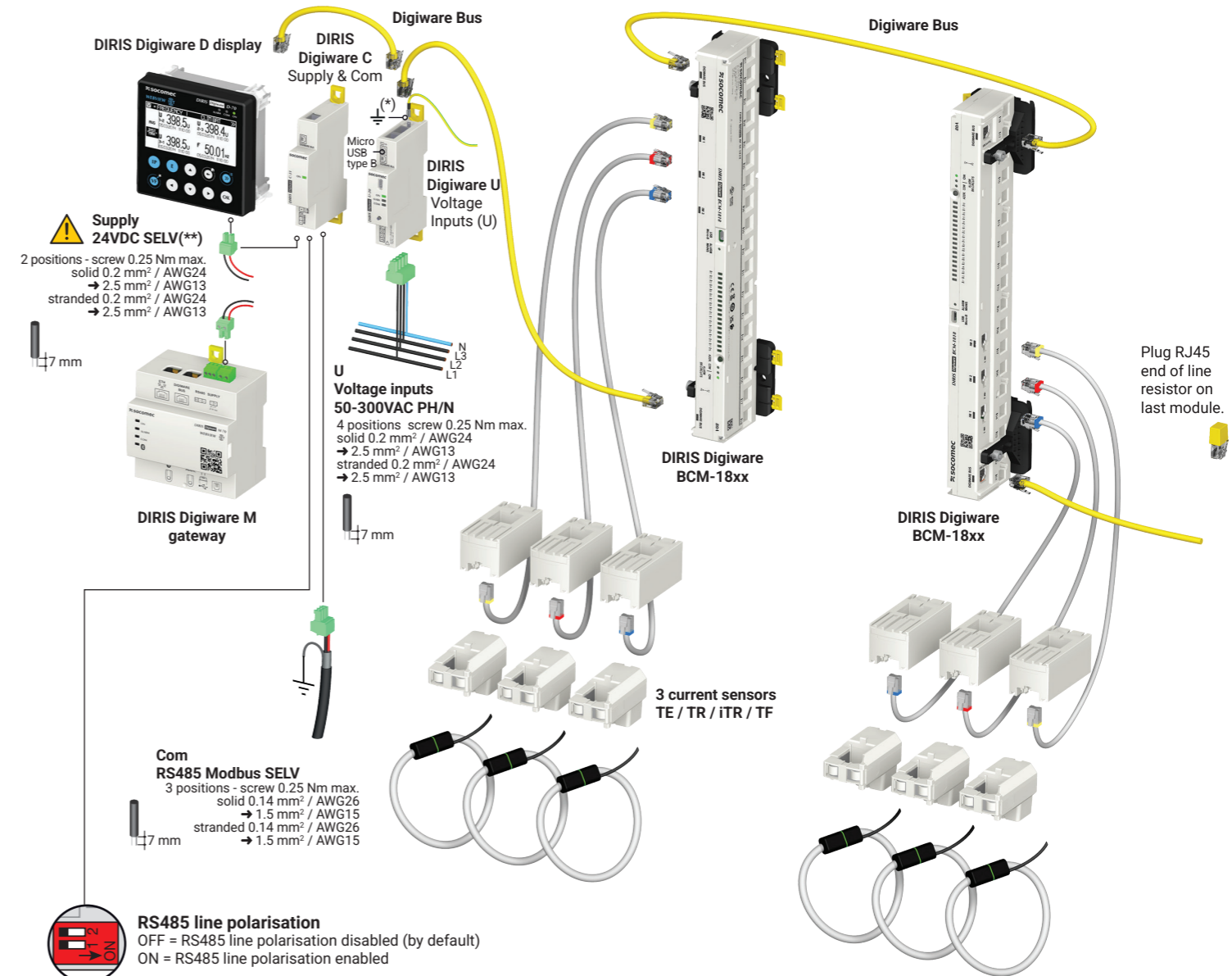

SELV : Safety Extra Low Voltage.  
(\*) Do not forget to connect earth to the DIRIS Digiware U module.

## 2. Dimensions [in]/mm

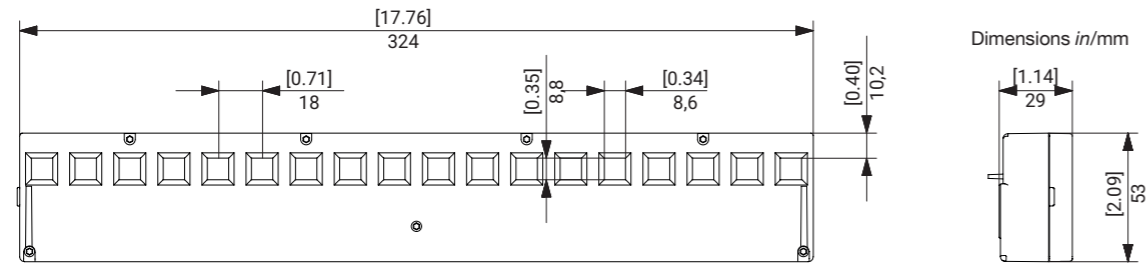

## 3. Mounting

### Back plate

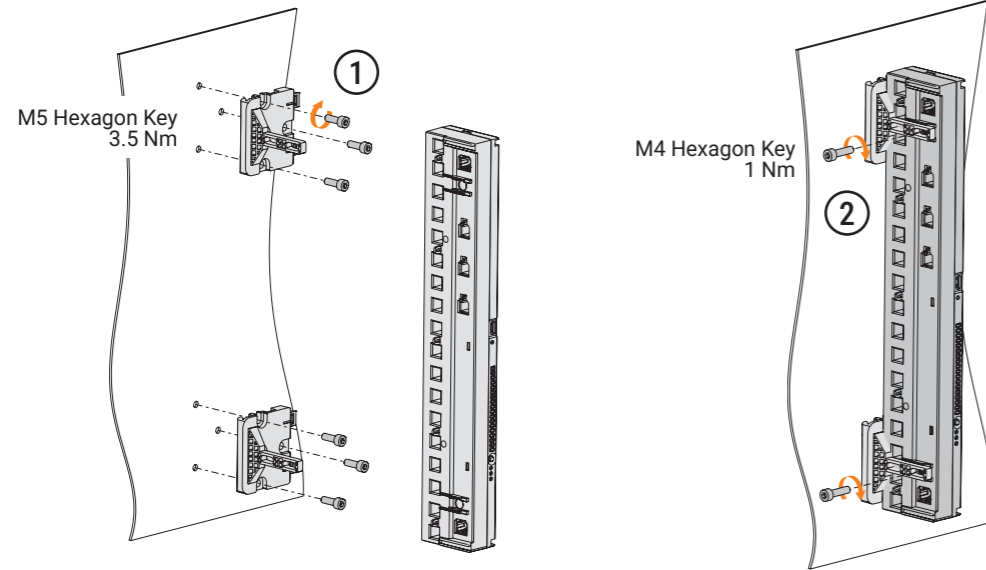

### DIN rail

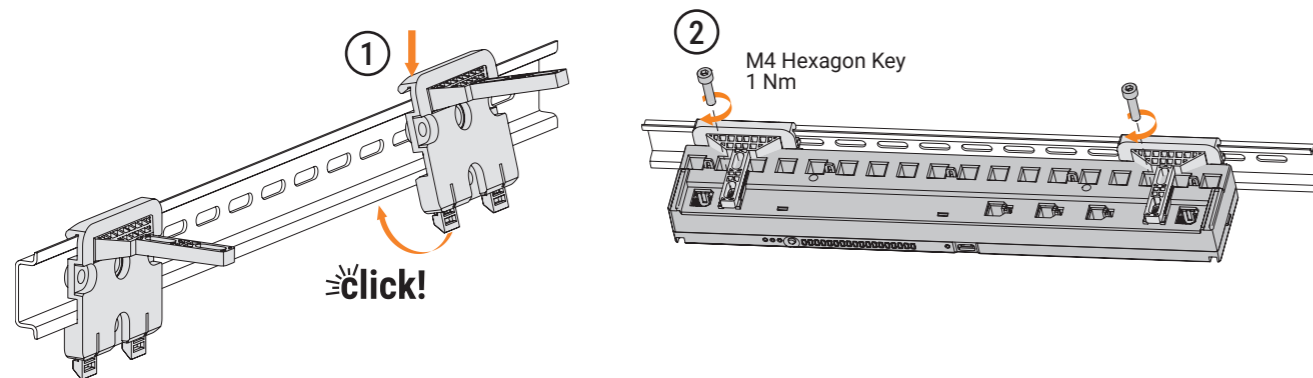

## 4. HMI

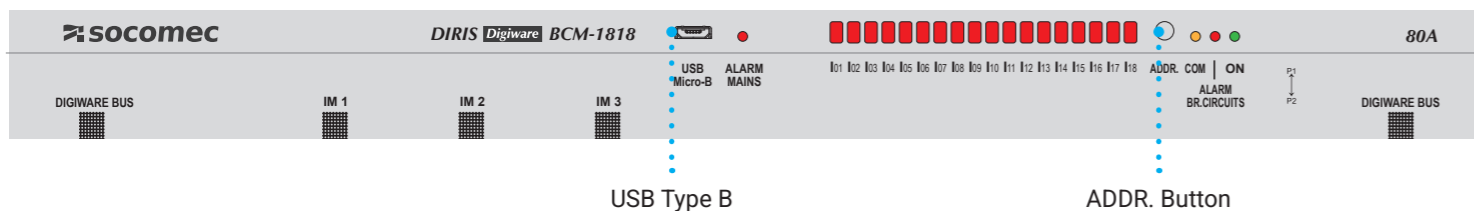

	FIXED	BLINKING
ALARM MAINS (Red)	Ongoing alarm (measurement, protection)	Ongoing system alarm (disconnected CT, V/I association, incorrect CT rating)
I01 - I18 (Red)	Indicates that no voltage is detected on a phase	-
COM (Orange)	Address conflict during Auto-Discovery process	Device is communicating
ALARM BR. CIRCUITS (Red)	Ongoing alarm (measurement, protection)	Ongoing system alarm (disconnected CT, V/I association, incorrect CT rating)
ON (Green)	Product powered and operating normally	When D-xx display is navigating on device and upon manual request (10 sec)

## 5. Technical characteristics

Measurement characteristics	
Nominal current I <sub>n</sub>	32 ... 63 A
Maximum current I <sub>max</sub>	80 A
Communication characteristics	
RJ45 Digiware bus	1 x Input / 1 x Output
Micro USB Type B	Configuration via Easy Config System software and firmware upgrade via Product Upgrade Tool software
Environmental characteristics	
Use	Indoor
Storage temperature	-20 ... +70°C (IEC 60068-2-1 / IEC 60068-2-2)
Operating temperature	-10 ... +55°C (IEC 60068-2-1 / IEC 60068-2-2)
Humidity	+25°C / 97% RH & +55°C / 93% RH (IEC 60068-2-30)
Operating altitude	≤ 2000 m
Pollution degree	2
Protection class	IP20*
Measurement category	III
Mechanical characteristics	
Vibration	10 ... 150 Hz, 1 g (IEC 60068-2-6)
Shock	Half-sine pulse, 15 g, 11 ms (IEC 60068-2-27)
Standards	
Measurement	IEC 61557-12 - Class 0.5 for active energy IEC 62053-21 - Class 0.5 for active energy ANSI C12.20 - Class 0.5 for active energy
Safety	IEC 61010-1 & IEC 61010-2-030 UL/CSA 61010-1 & 61010-2-030 Guide FTRZ/PICQ File E257746

(\*) IP ratings not evaluated by UL.

## 6. Panelboard view

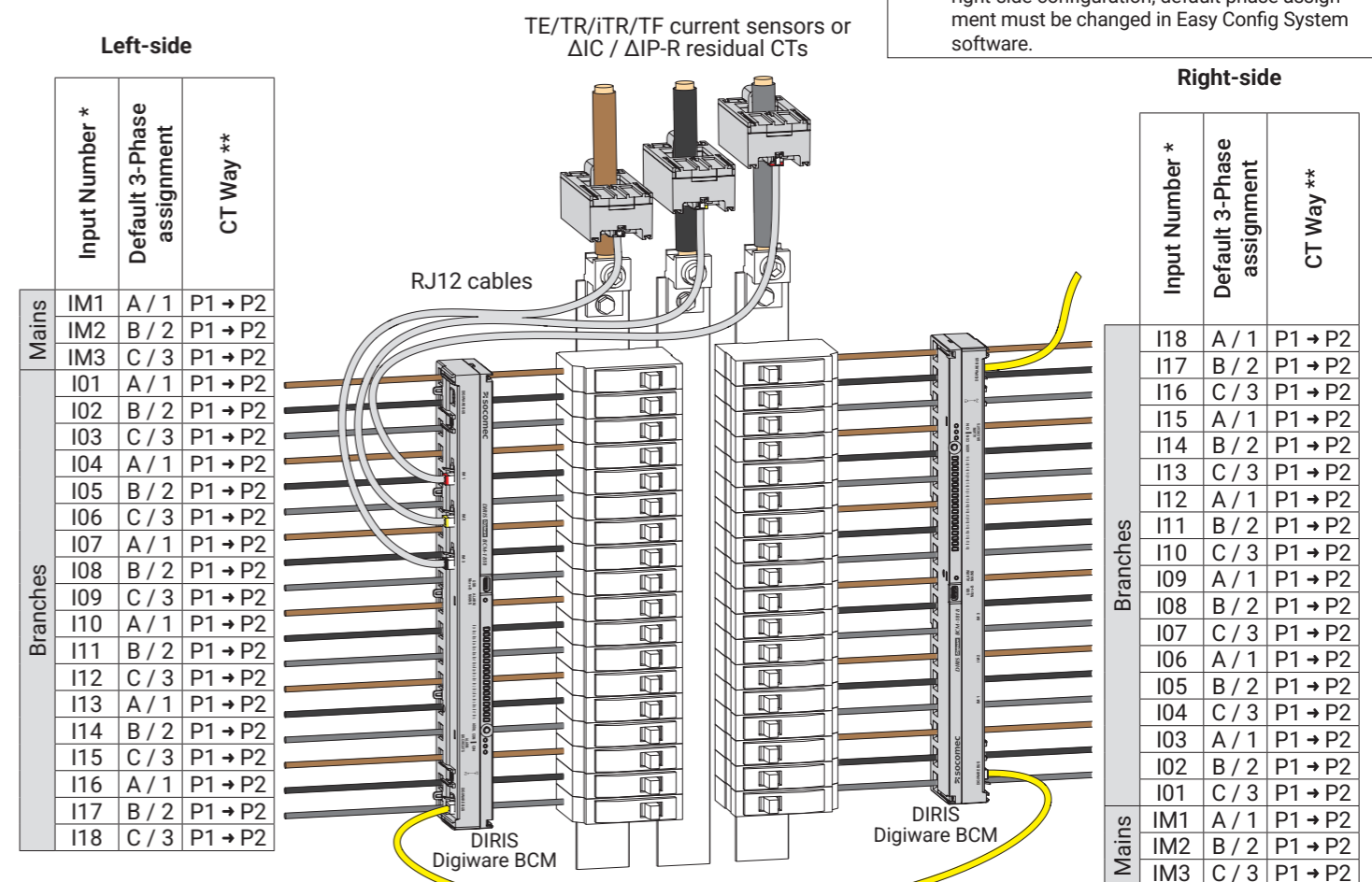

⚠ When installing the DIRIS Digiware BCM in a right-side configuration, default phase assignment must be changed in Easy Config System software.

⚠ For direct current inputs, install on 300 V insulated cable only.  
(\*) Refer to product marking for input number.  
(\*\*) CT Way can be changed in Easy Config System software if necessary.